

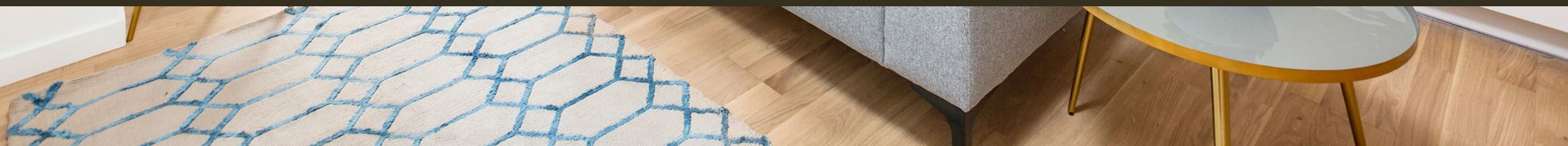

Meranti Apartments, Deptford  
London SE8

GARTONJONES.COM



## Meranti Apartments, Deptford London, SE8

### £370 Per Week

A fantastic 1-bedroom apartment offering 560sq.ft (52sq.m) in Meranti Apartments, Deptford Landings SE8. Comprising a large, bright, open-plan living space with floor-to-ceiling windows that open onto a private terrace overlooking the communal gardens, a stylish contemporary bathroom, and a spacious bedroom with fitted wardrobes. Residents benefit from underfloor heating and security from CCTV monitored entry and exit points. The facilities include ground floor secure cycle storage and landscaped communal gardens. Situated just 0.7 miles from Deptford Rail Station and Surrey Quays Station which are serviced by Thameslink and South Eastern lines and Overground lines respectively. South Bermondsey is a little over a mile away for all Southern Line services providing easy access to the whole of central London.

- 560 sq.ft
- Double Bedroom
- Luxury Bathroom
- Open Plan Reception Room
- Smart Integrated Kitchen
- Lovely Garden Aspect
- 24 Hour Concierge
- Cycle Storage, Communal Gardens
- Parking by Separate Request

GARTON JONES.COM

9 Albert  
Embankment  
London  
SE1 7SP

Lettings:  
+44 (0) 20 7735 1888  
nineelms@gartonjones.com  
www.gartonjones.com





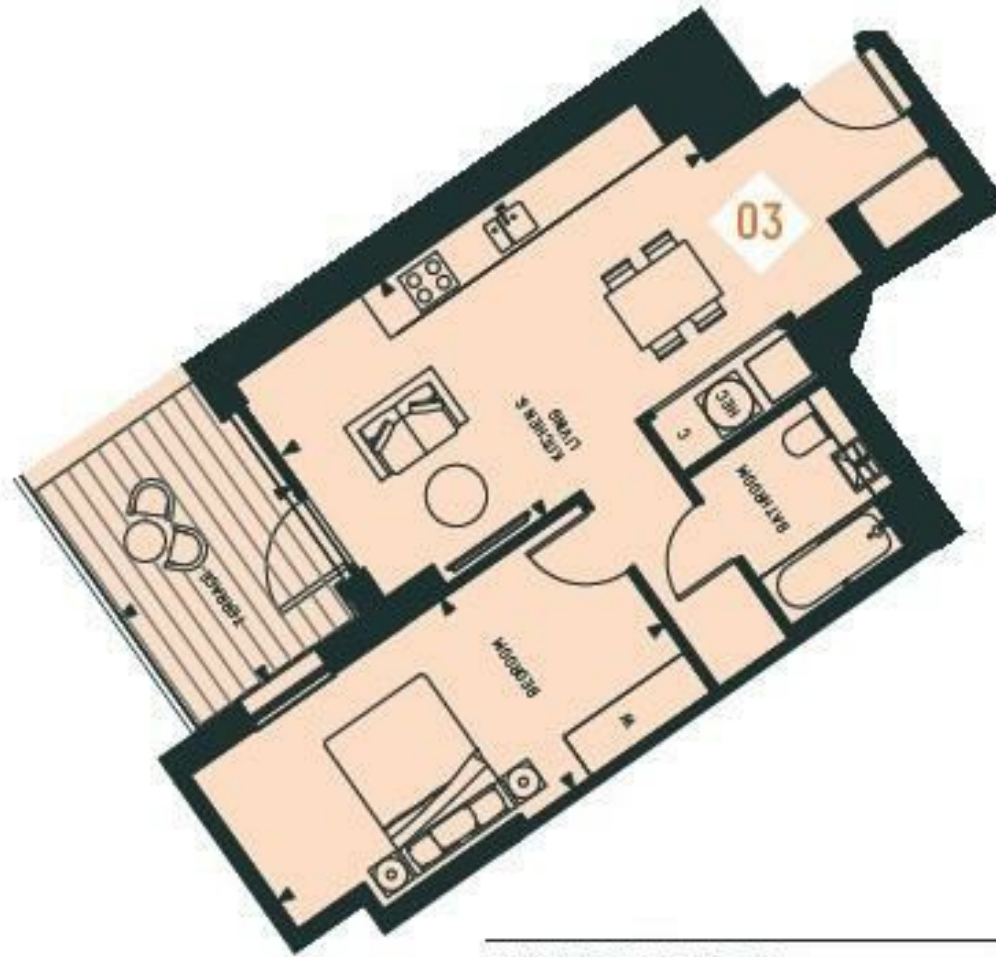

INTERNAL AREA	52.1 SQ M	560.8 SQ FT
LIVING/KITCHEN/DINING	3.5 X 6.3M	11'5" X 20'7"
BEDROOM	2.8 X 5.8M	9'2" X 19'0"
TERRACE	19.3 SQ M	207.7 SQ FT

